



**Finsa  
Process**

# Excel- Cab

Flat Pack Kitchen Cabinet

# Excel-Cab

## Baseboard



### Fimaplast STD

Manufactured on a Fimaplast surface. The melamine coating allows for easy cleaning, scratch resistance and an antibacterial surface.

### Edging

PVC 1 mm front, PVC 0.4 mm other.

### Back

Standard MFC Fimaplast 6 mm, white (both sides) for wall units and larder units.  
Standard MFC Fimaplast 18 mm, white (both sides) for base units.

### Assembly

Cam Dowel and Wooden Dowel.

### Packaging

Flatpack product in cardboard with honey comb reinforcements.

### Technical specifications

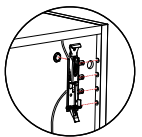

Mechanised and hidden hanger included

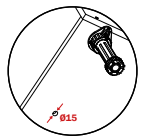

Legs included

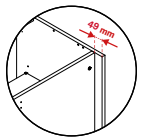

Service void to allow for plumbing, electrics and ventilation

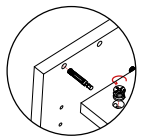

Cam Dowel Assembly

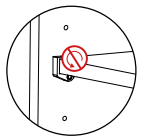

Shelf support

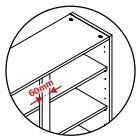

Centre Post on units 700 mm wide or above

## Designs

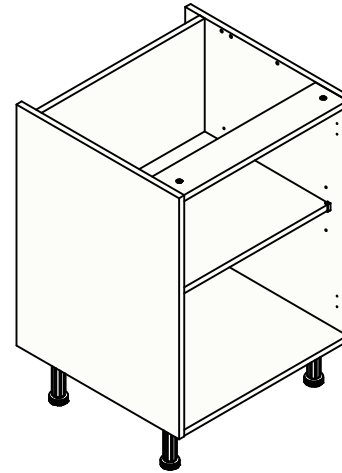

O20 Blanco Medio  
SOFT III | DUO

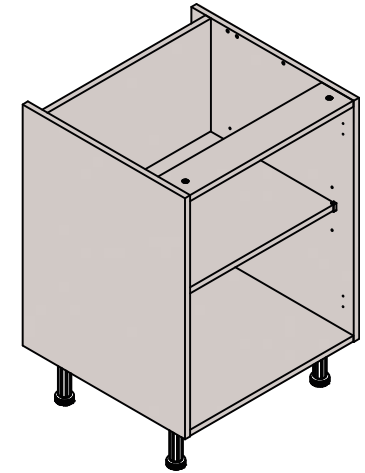

U12 Natural Grey  
SOFT III | DUO



# Antibacterial surface

The growing demand for products that prevent the development of harmful germs to health has led us to work in that field, looking for materials that can meet these requirements. The Excel-Cab range is made by melamine, an antibacterial tested surface.



## Analysis Certificate

Imsl  
Industrial microbiological services (uk)  
www.Imsl-uk.Com

Certificate n°, 1023308,1b

Method: calculation of the antibacterial activity by using iso 22196: 2011

Results (as cfu cm-2)

Sample	Contact	Time	Reduction	% Difference
Gama Duo	E. Coli	1,7e+04	< 1,0	> 99,99%
Gama Duo	S aureus	2,0e+04	< 1,0	> 99,99%

The above data shows the difference between the initial and final bacterial populations after contact with the surface of the referenced samples for 24 hours at 35°C and a relative humidity of 95%.

Our melamine surface has been tested by an external laboratory, the IMSL (Industrial Microbiological Services) in the UK, following the procedures outlined by ISO

22196: 2011, confirming that our melamine includes features that inhibit the growth and development of bacteria without harming the characteristics of the coating.

# Packaging

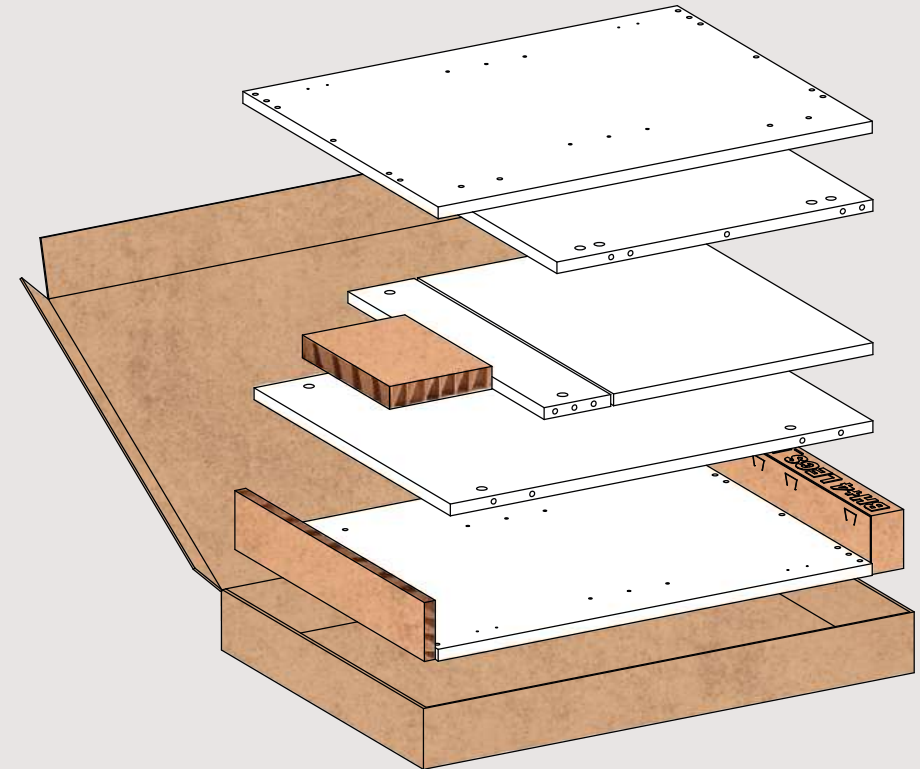

## More Conscious Packaging

1. Better quality, externally (thicker) and internally (honeycomb reinforcements), which will minimize the number of damages.
2. Internally, a series of fillers are proposed that minimize the movement, blocking the different items inside the box, which makes it less prone to damage during transport.
3. Recyclable cardboard is used both externally and, in the fillings, avoiding the use of plastic.
4. Better flat pack appearance,
5. Stacking on the pallet is optimized, improving pallet handling safety.

# Live Sustainably

## Eco-certified

We strongly believe that transparency and external certification is important for you as a consumer. This is the only way for you to ensure that there is substance behind it all.

We can only encourage you to look for facts and recognised certifications with any brand you consider engaging with.



The Excel-Cab range is FSC certified. FSC® certified forests are given time to naturally regenerate itself, and consideration of the local wildlife is taken into account, as well as the well-being of the forest workers.



**FINSA**HOME

[finsahome.co.uk](http://finsahome.co.uk)

